



### Product Description

1. Dual seal configuration
2. Balanced design
3. Independent of direction of rotation
4. Cartridge construction
5. Designed for bottom entry vessels
6. Rotary unit with multiple springs
7. Construction with integrated bearing

### Technical Features

1. Over all connecting dimensions are tailor made to customer's specifications
2. Specially designed to handle high operating pressure
3. Product side is equipped with floating throttle bush
4. The seal design is unique as it closes due to the hydraulic product pressure as well overlaying barrier pressure
5. Rugged design to ensure long term reliability and operating life
6. Seals are assembled in cartridge construction for easy fitment

### Typical Industrial Applications

Chemical industry  
Suitable for all media  
Agitators

### Performance Capabilities

Shaft diameter:  $d_w = \dots 400 \text{ mm}$  (... 15.75")  
Pressure:  $p_1 = \text{vacuum} \dots 60 \text{ bar}$  (870 PSI)  
Temperature:  $t = -40 \text{ }^\circ\text{C} \dots +200 \text{ }^\circ\text{C}$  (-40  $^\circ\text{F} \dots +392 \text{ }^\circ\text{F}$ )  
Sliding velocity:  $v_g = 0 \dots 5 \text{ m/s}$  (0 ... 16 ft/s)  
For applications beyond this range, please enquire.

### Materials

According to application and customer's specification

### Notes

Options:  
Cooling or heating flange  
Leakage drain, flush or heating flange  
Leakage drain or flush

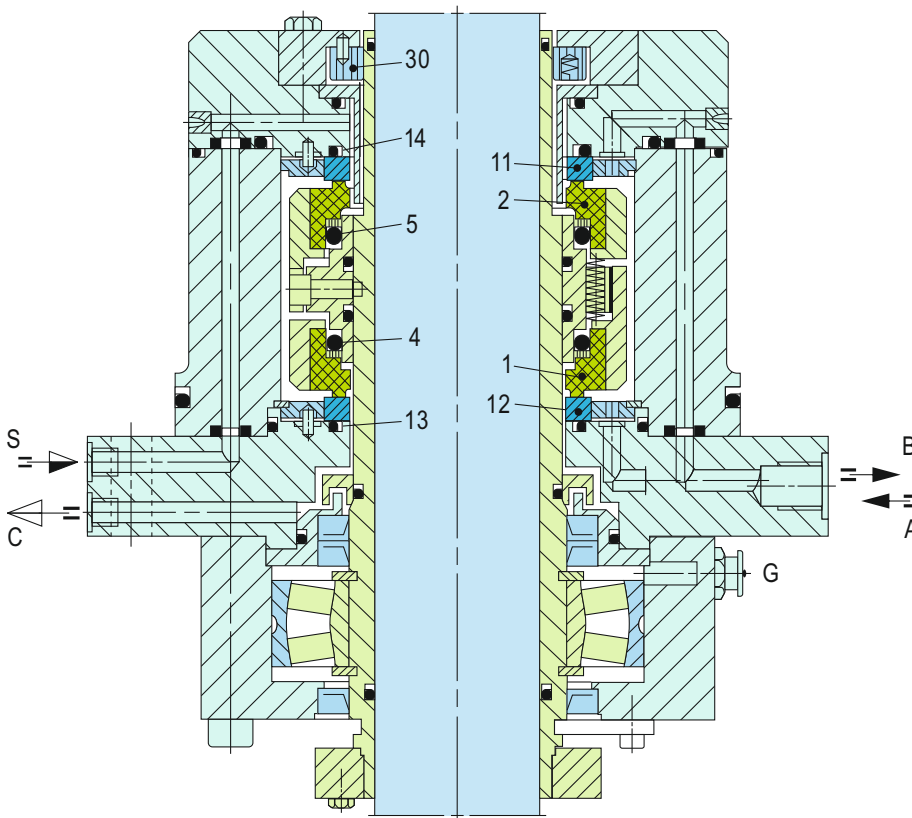

Item	Description
1	Seal face, atmosphere side
2	Seal face, product side
4, 5, 13, 14	O-ring
11	Seat, product side
12	Seat, atmosphere side
30	Throttle ring

### Installation, Details, Options

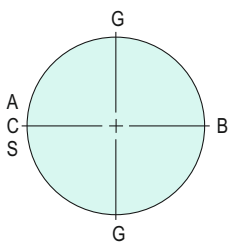

#### Supply connections

- A Barrier fluid IN
- B Barrier fluid OUT
- C Drainage
- G Grease
- S Flush

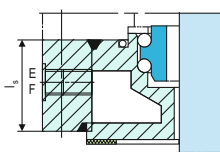

**Option**  
Cooling flange, can be used alternatively as a heating flange ( $t_{max} = 350 \text{ }^\circ\text{C}$  (662  $^\circ\text{F}$ )).

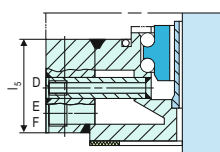

**Option**  
Leakage drain, can be used alternatively as a flush or as a heating flange.

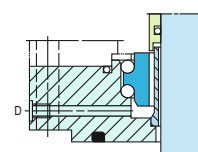

**Option**  
Leakage drain, can be used alternatively as a flush.

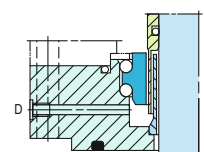

**Option**  
Polymerization barrier, can be used alternatively as a leakage drain or a flush.